

Main advantages:

- “Stick & Measure” concept
- Low immobilisation of your specimen
- Flexible support : Ideal for flight test, wind tunnel wind turbine & automotive application
- Flush sensor
- Ideal to find out an acoustic source
- Fast installation onto your structure without damage
- High performances for flight test applications (Transonic ; aerobatics)

CaptiFlex® Technology is patented

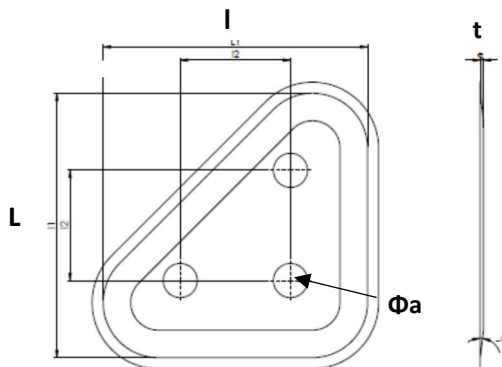

Reference: C-C-MO-L-l- Φ_a -t-serie

Product references: (for other sensors, contact us)

Sensor	Ref CaptiFlex	L(mm)	l (mm)	Φ_a (mm)	t (mm)
B&K 4948/4949	C-C-MO-240-100-20-3.2	240	100	20	3.2

Main technical specifications (other specifications, contact us):

- For three sensors of pressure or acoustic for wall measurement
- For setting up to plane surface or low curved as liner aircraft fuselage (Φ 4m)
- Pressure min/max : 250hPa (3.6PSI) /1500hPa (21.7PSI)
- Temperature min/max : -40°C (-40°F)/+80°C (176°F)
- Load factor min/max : -1g/+5g
- Max speed & max altitude : M0.92 (Transonic), 420 Kts, 40 000'
- Roughness Ra 0.4 μ
- Waterproof against water projection

Instruction for use:

- In workshop, sensor is set up on a specific support in order to be flushed and to be decoupled from the structure
- Then the entire system is stuck onto your structure

Accessory/ Options:

- LMSM could add a connector to the sensor wires and could shield them
- Combined with TransiFlex, sensor wire installation is quicker and increases quality measurement
- Specific support for sensor

How to Order:

lamesuresurmesure@orange.fr

Contact our specialist at + 33 6 30 80 85 66

42 avenue Paul Cézanne 13090 Aix-en-Provence, France